

CORNER RESTORATION

W1/4 COR.
CORNER Sec. 18 **TWP.** 10 S. **RANGE** 28 E.

ORIGINAL SURVEY BY: Everett Thacher Retracement by: Aaron F. York

CONTRACT NUMBER: 325 394

CONTRACT DATE: June 4, 1879 May 26, 1881

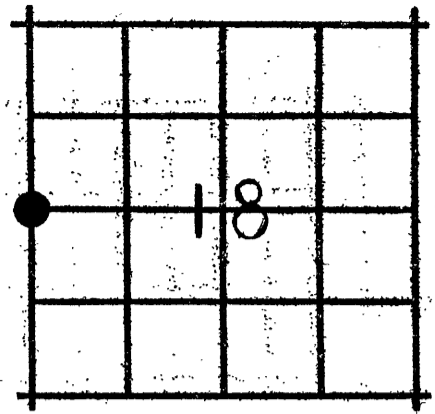

ORIGINAL DESCRIPTION: Set stone 25"x7"x5" for 1/4 sec. cor.

Raised stone mound at cor.

GLO retracement by Aaron York: I find 1/4 sec. cor. a stone 25"x6"x6" in a stone mound.

RESTORATION BY, STAMP AND DATE:

R.D. Bagett
 R.G. Ward

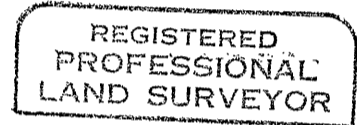

Robert D. Bagett
 OREGON
 JULY 12, 1983
 ROBERT D. BAGETT
 598

Oct. 24, 1990

EVIDENCE FOUND: After a diligent search I found no evidence of the original corner. I declare this corner lost and establish it's position at single proportionate measure between the NW cor. section 7 and the NW cor. section 30.

RECEIVED AND FILED

NOV 12 1990

OFFICE OF COUNTY SURVEYOR
Robert D. Bagett
 Attest: *Jeremy Russell*

See Record Map of Survey No. 1157.

DESCRIPTION OF MONUMENTS AND ACCESSORIES SET AND METHODS USED:

Show how trees are scribed and basis of bearings, including compass var.

MONUMENT MARKED

At the corner point: I set a 2 1/2"x30" Galv. Iron pipe, 30" in the ground, with attached Brass Cap marked as shown.

- From which I SCRIBE NEW BEARING TREES:
 A P. Pine 8"diam., bears S89°W, 47.6 ft. marked 1/4S13 BT.
 A P. Pine 6"diam., bears N14°W, 60.5 ft. marked 1/4S13 BT.

- Also I SET NEW REFERENCES POINTS:
 A 5/8"x30" iron pin, bears N87°E, 8.10 ft., with attached plastic cap marked BGA SURVEY MARKER.
 A 5/8"x30" iron pin, bears S11°E, 8.11 ft., with attached plastic cap marked BGA SURVEY MARKER.
 Used mag. compass with 20°E. var. and a steel tape, measuring to a 50d nail driven in the sidecenter at the root crown of the BTS. Painted blazes with red timber marking paint and attached BGA BT tags.

